

# GOLDBERG BROTHERS, INC.

## Barn Door Edge Wrap - Installation Instructions

### Included Hardware

Edge Wrap Side Channels  
Wood Screws

Edge Wrap Top & Bottom Channels  
Metal Screws

Roller Hanger Shims

Adjustable U-Guide

### IMPORTANT NOTES

All edge wrap channels should fit snugly on your door with no visible gaps between face returns.

For smaller door sizes, the side channels can be cut off on the bottom, and the top and bottom can be cut and notched on either side.

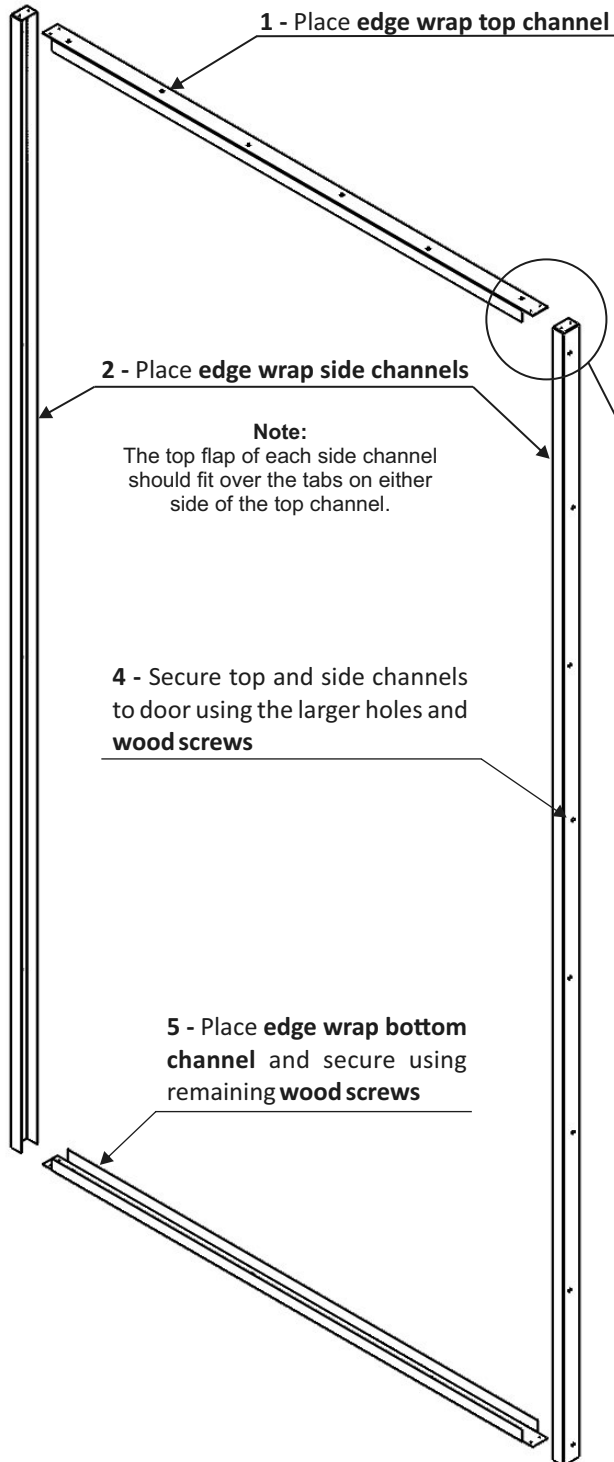

### Shims

The shims provided are intended for use with Goldberg Brothers *Standard Series J-Strap*, *MP Series Straight Strap*, or *Shutter Series Straight Strap* roller hangers ONLY.

Standard Strap Shim



MP Strap Shim



Shutter Strap Shim



To install, place shims directly behind each hanger on the front face of the door.

**Note:** The top edge of each shim should be tight against the edge wrap top channel. For the **standard strap shim**, either end can be used.

*Each shim can be used as a drilling template for your hanger installation. Be sure to review your hanger installation instructions for proper placement.*

*\*Images not to scale. Product lengths and proportions may differ from images shown here.*

Goldberg Brothers barn door track and hardware sets come with a one-year manufacturer's warranty for defective parts under normal installation and use. Warranty is subject to repair or replacement of defective components at manufacturer's discretion and does not include installation costs. With the exception of our stainless steel products, Goldberg Brothers does not warrant any products installed and used outdoors or where they are exposed to weather, running water or water condensation. Under these conditions, rust and other damage will naturally occur. This warranty does not include loss of defects caused by elements outside the control of Goldberg Brothers, Inc., such as natural disasters, weather, fire, water leakage, abuse, improper installation, or anything else deemed out of the control of Goldberg Brothers, Inc.

This document contains proprietary information of Goldberg Brothers, Inc. and its receipt of possession does not convey any rights to reproduce or disclose its contents, or to manufacture, use or sell anything it may describe. Reproduction, disclosure, or use without prior written authorization from Goldberg Brothers, Inc. is strictly forbidden.

Goldberg Brothers, Inc.  
10488 W Centennial Rd, Suite 100  
Littleton, CO 80127  
(303) 321-1099